



2-Ton Utility Dump/Trailer Wagon

Stock No. 2TW/03168



Assembly Instructions

Assembly Instructions

1. Install four wheel/tire assemblies onto wheel carrier. Secure with 1" flat washer and cotter pin.



2. Install tongue assembly by , first attaching tongue rear to main chassis using the 1/2" X 4-1/2" bolt, lock washer, and nuts.

3. Install floor boards (not provided).

4. Install tailgate and front panel supports by securing to rear and front of bed frame using 3/8" X 1" bolts, washers, and nuts.



5. Insert three (3) each 1 X 6 sideboards (not provided) and two (2) each side support stakes on each side. Install tailgate and front panel.



Note: If you desire to install a dump cylinder, the attachment holes are already available on the main chassis and the bed to fit a standard 24" stroke agriculture cylinder with up to a 4" diameter piston.

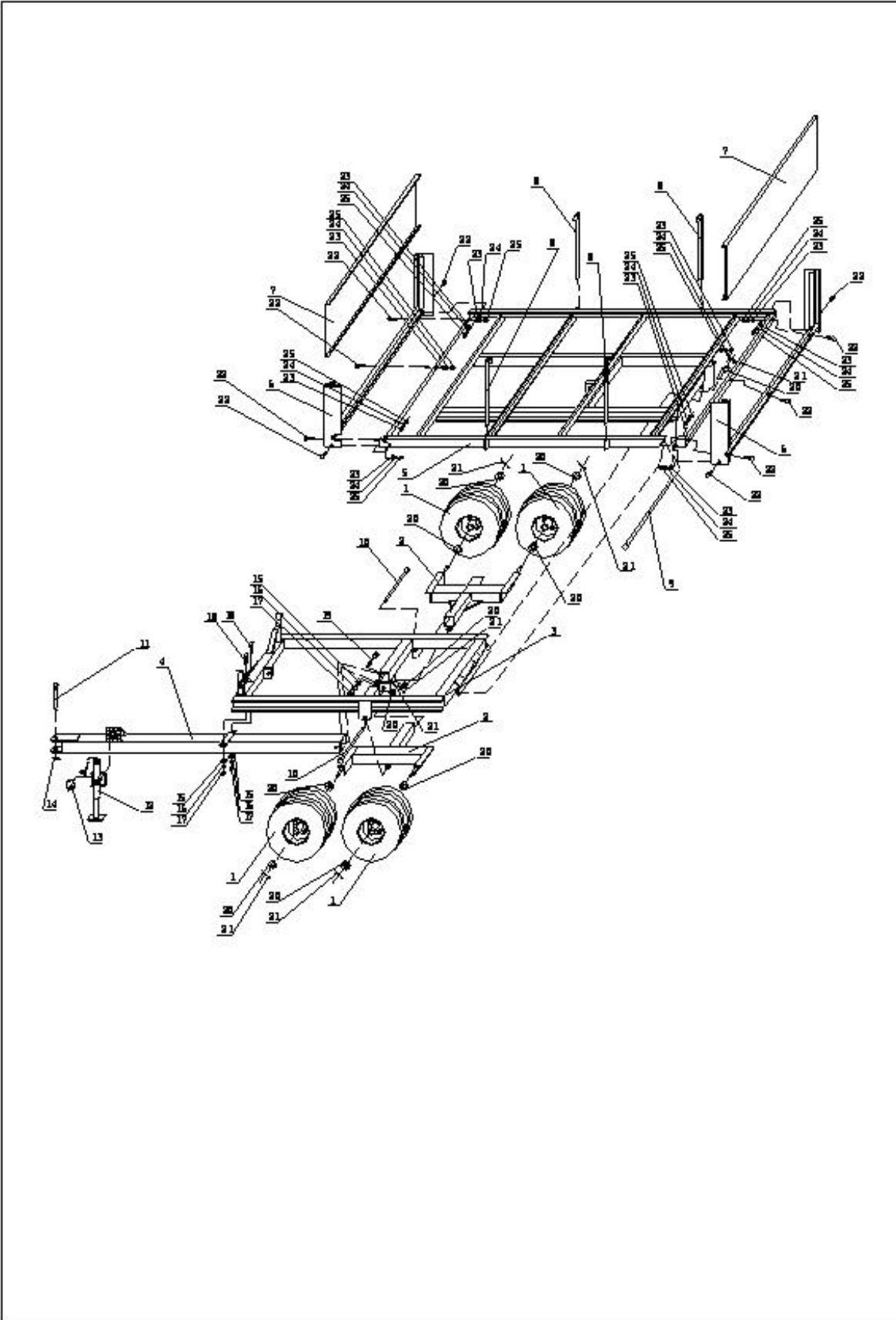

1	Tire	16	Lock Wash
2	Wheel Support	17	Nut M12
3	Base Rail	18	Bolt M12x30
4	Draw Rail	19	Bolt M12x120
5	Body Frame	20	Wash
6	Front/Rear Frame	21	Pin
7	Front/Rear Fence	22	Bolt M10x25
8	Fence Pin	23	Wash
9	Axle	24	Lock Wash
10	Wheel Axle	25	Nut M10
11	Draw Pin		
12	Trailer Jack		
13	Ring		
14	Pin ϕ		
15	Wash		